

# **MATRIX**

**C04H0802.**

Install Instruction

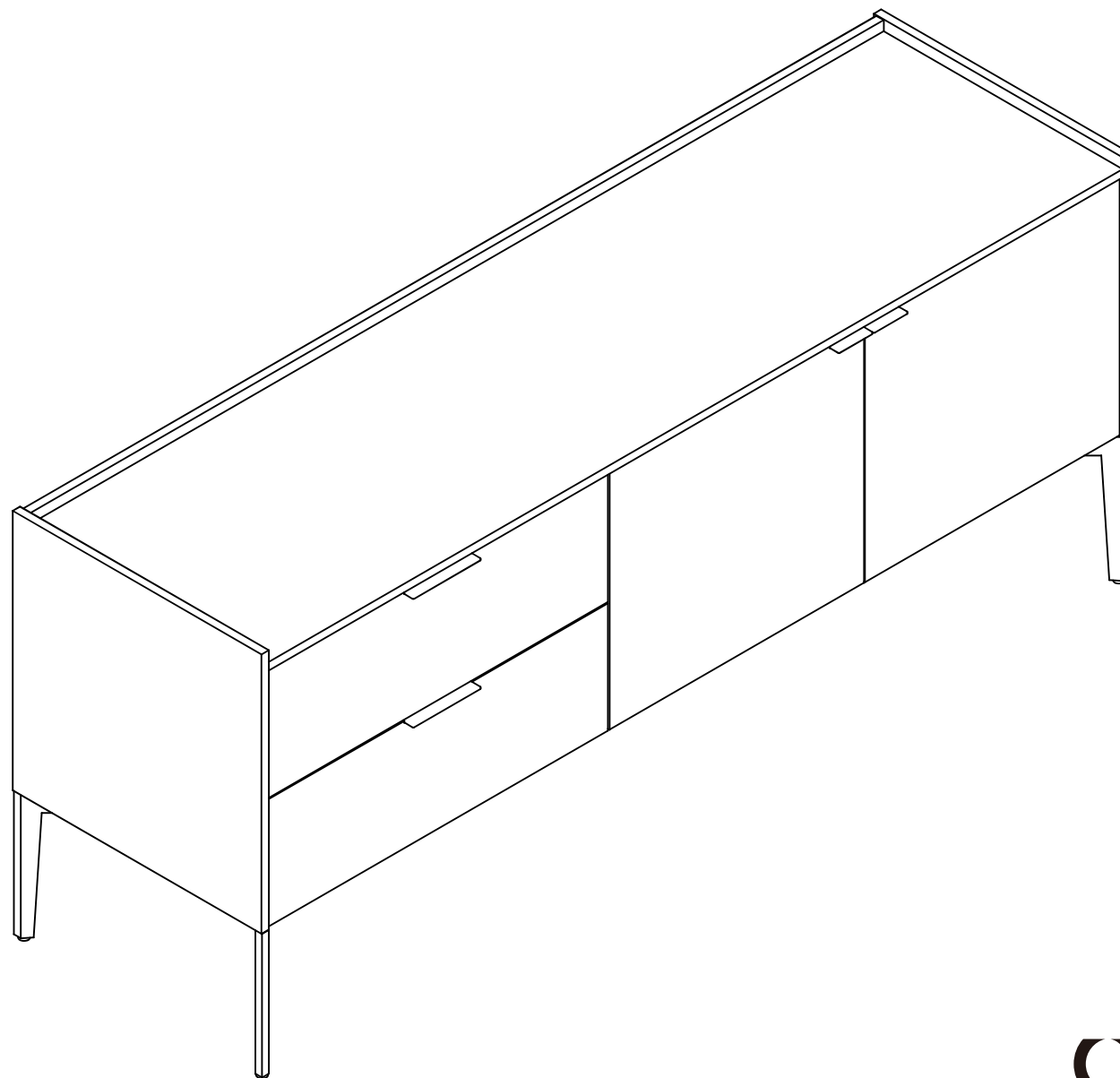

**CAMERICH**

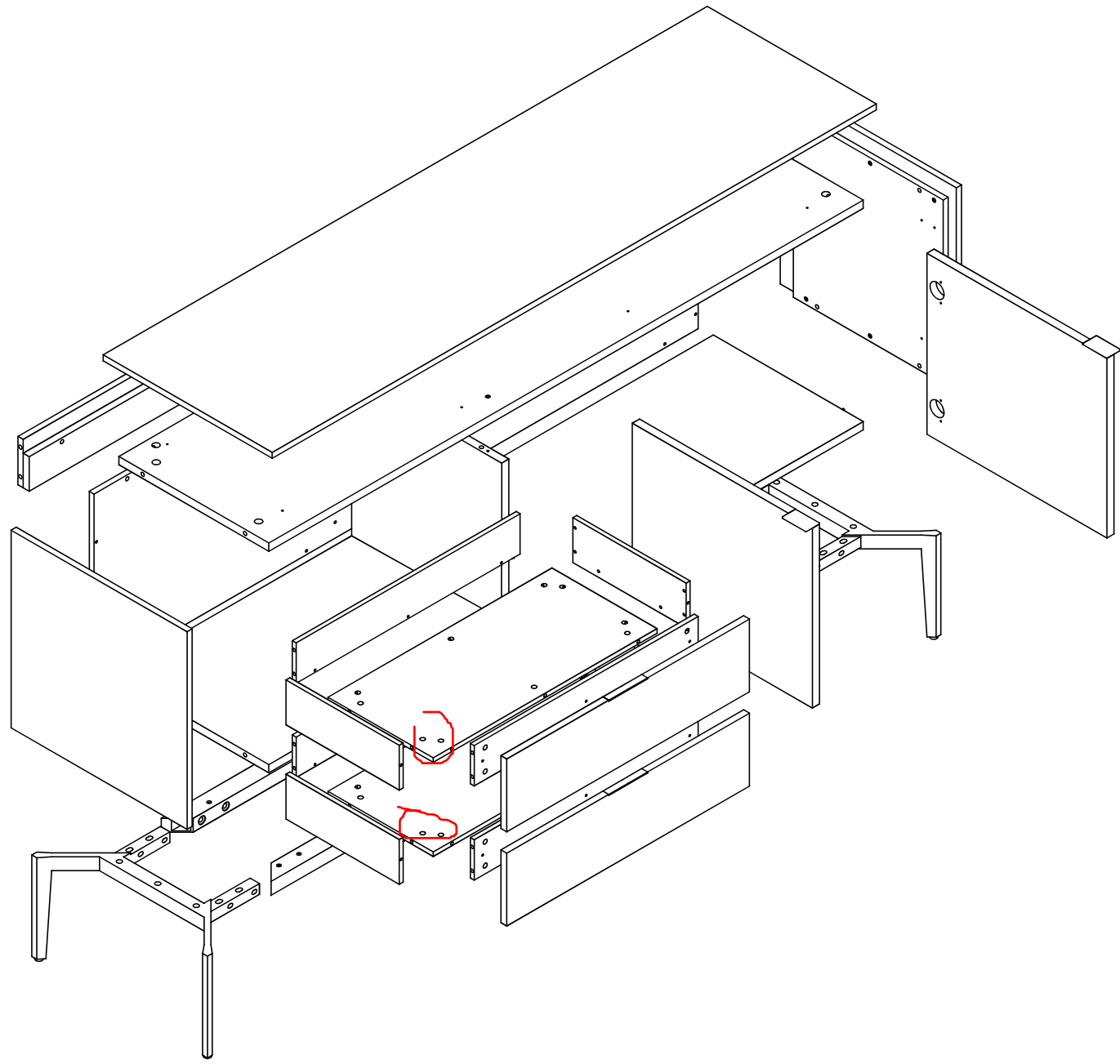

A  
 $\Phi 8 \times 30 = 4$

B  
 $M5 \times 50 = 14$

C  
3mm=1

D1  
15mm=12  
D2  
=12

E1  
12mm=40  
E2  
=40

F  
 $M8 \times 35 = 8$

G  
5mm=1

H  
 $M8 \times 40 = 18$

I  
 $M4 \times 12 = 32$

J1  
=4

J2  
=4

J3  
=4

J4  
=4

K  
=2

L  
 $\Phi 6 \times 30 = 4$

M  
 $M4 \times 25 = 6$

N  
2.5mm=1

O  
=2

P  
=8

Q  
 $M4 \times 16 = 16$

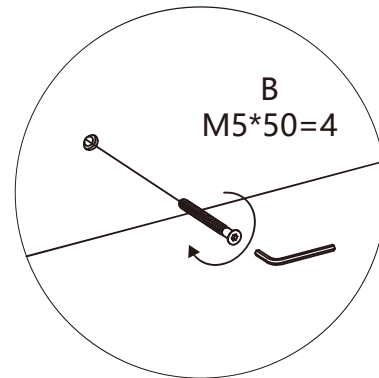
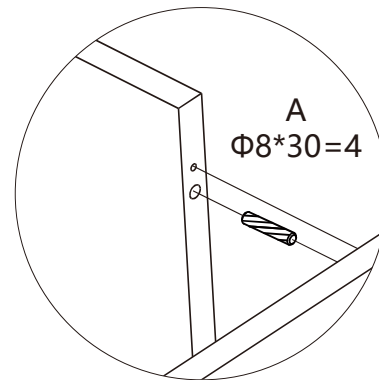
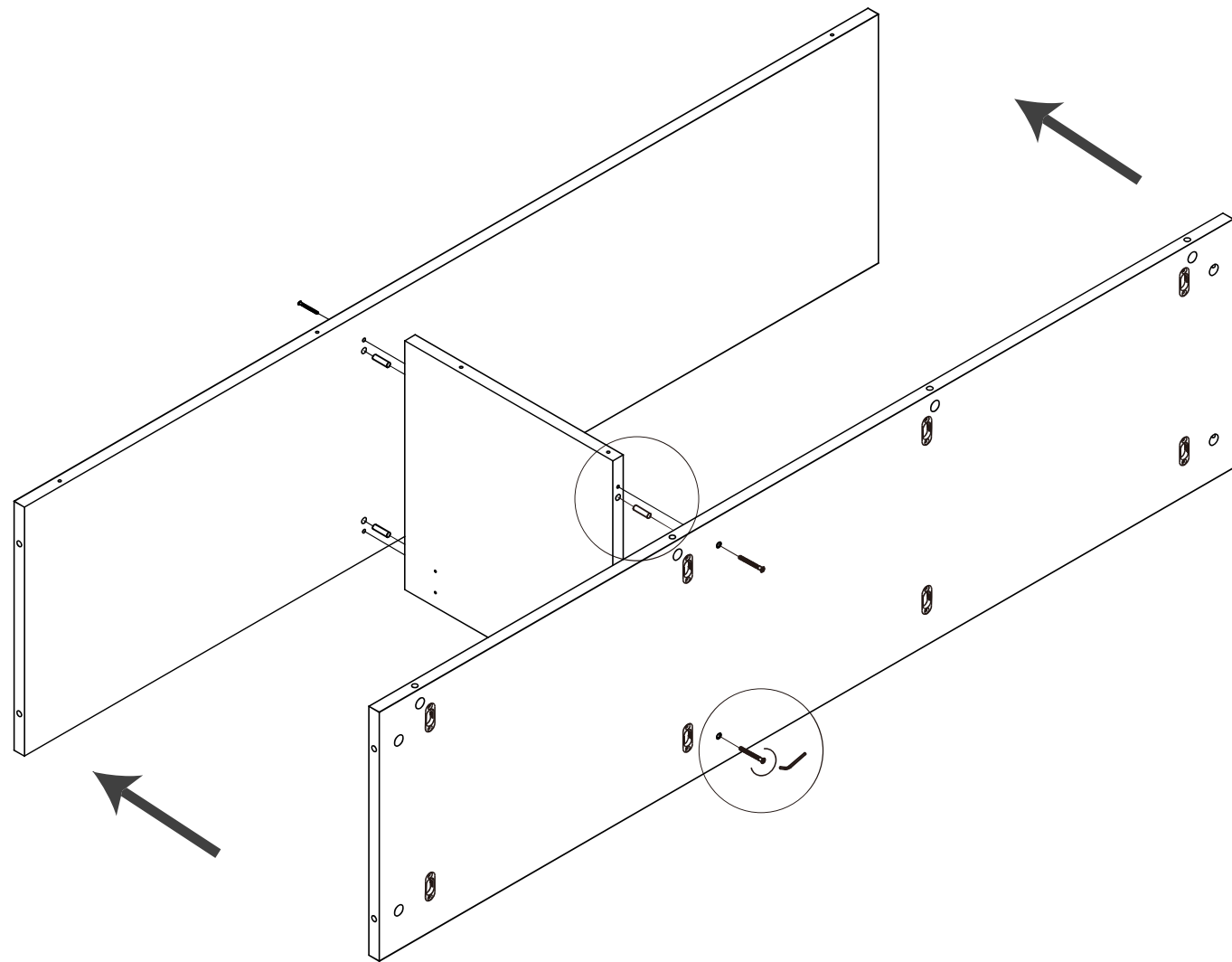

 A  
 $\Phi 8 \times 30 = 4$

 B  
 $M5 \times 50 = 4$

 C  
3mm=1

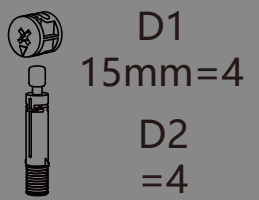
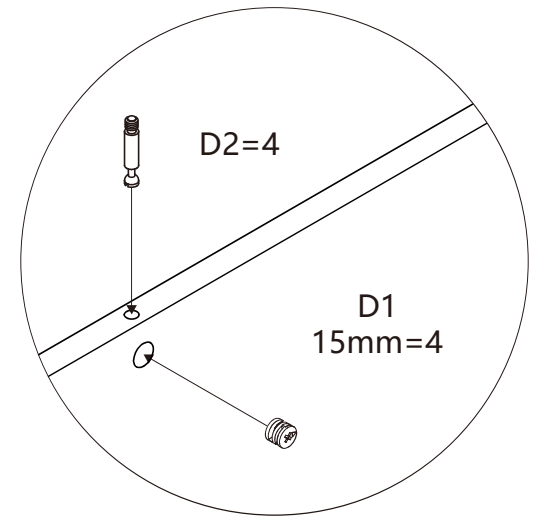
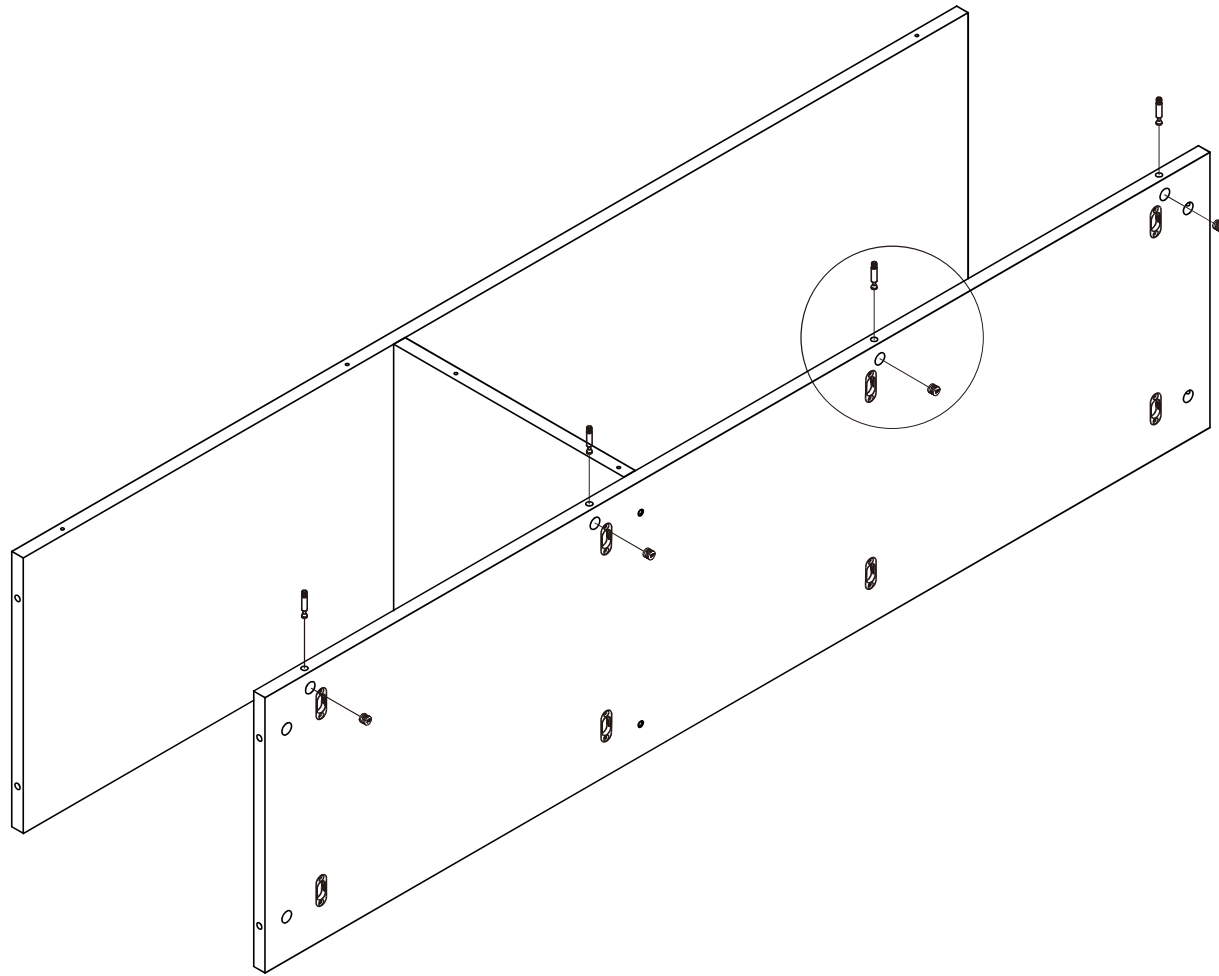

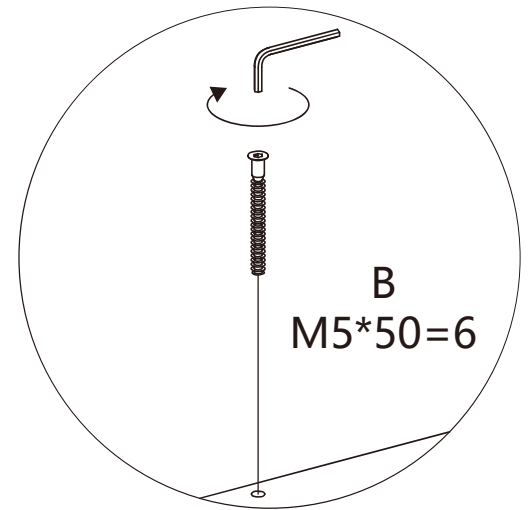
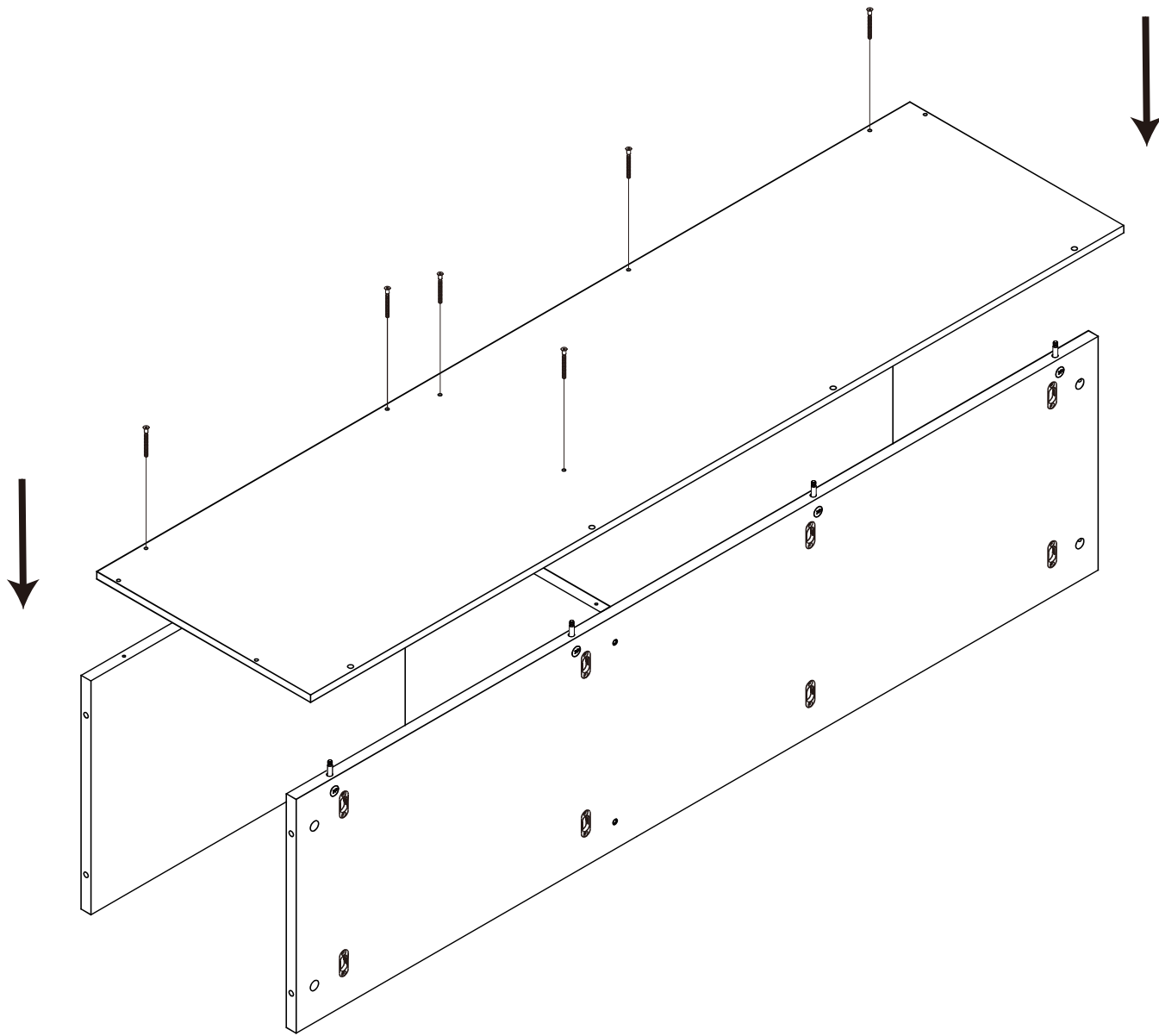

 B  
M5\*50=6

 C  
3mm=1

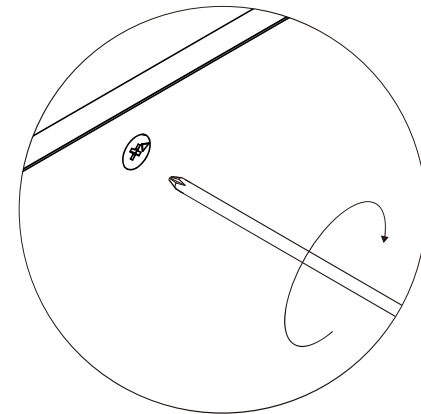
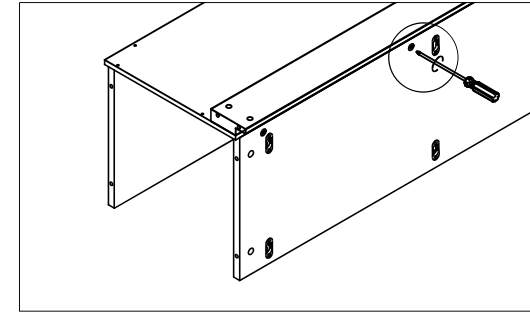
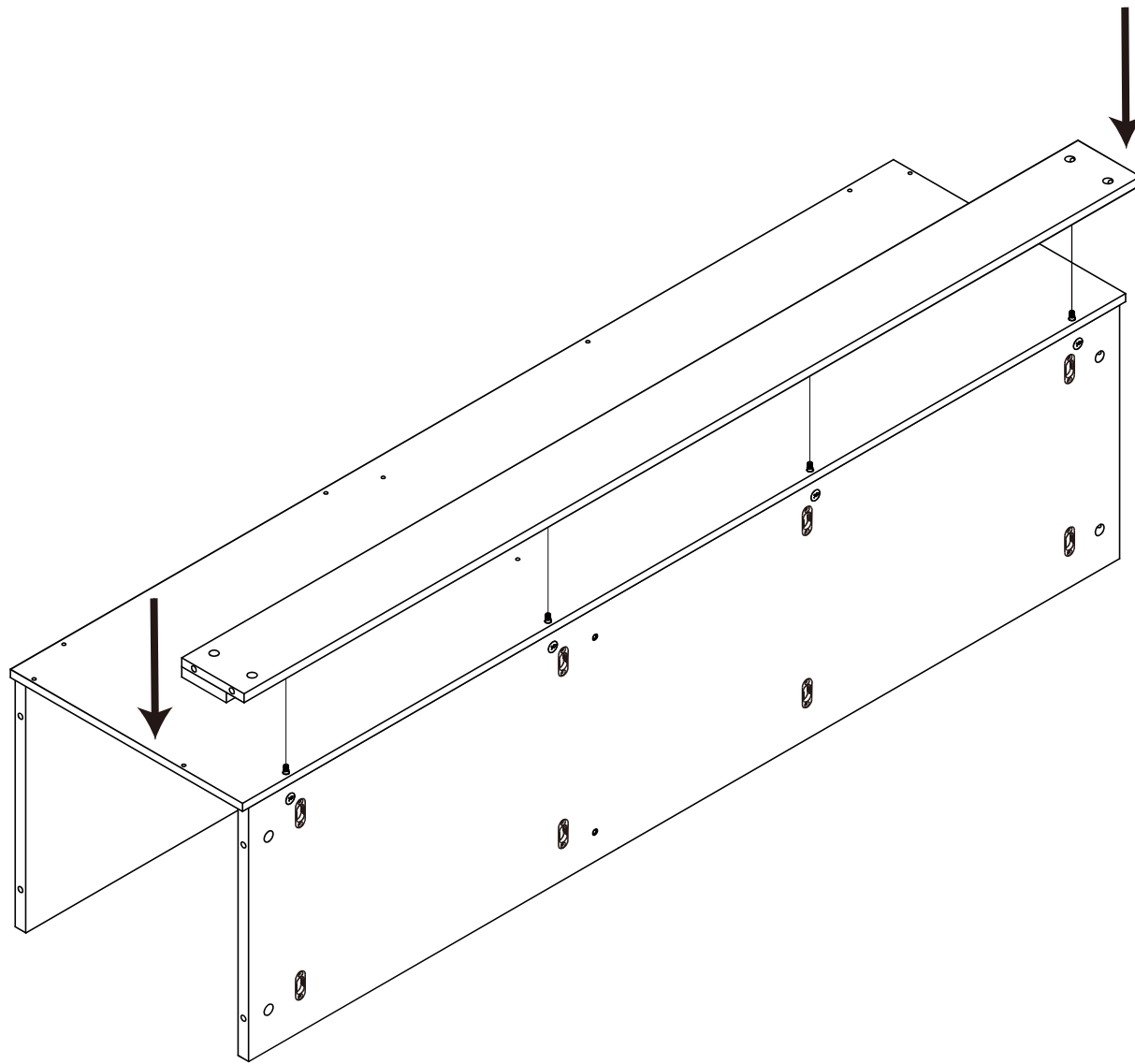

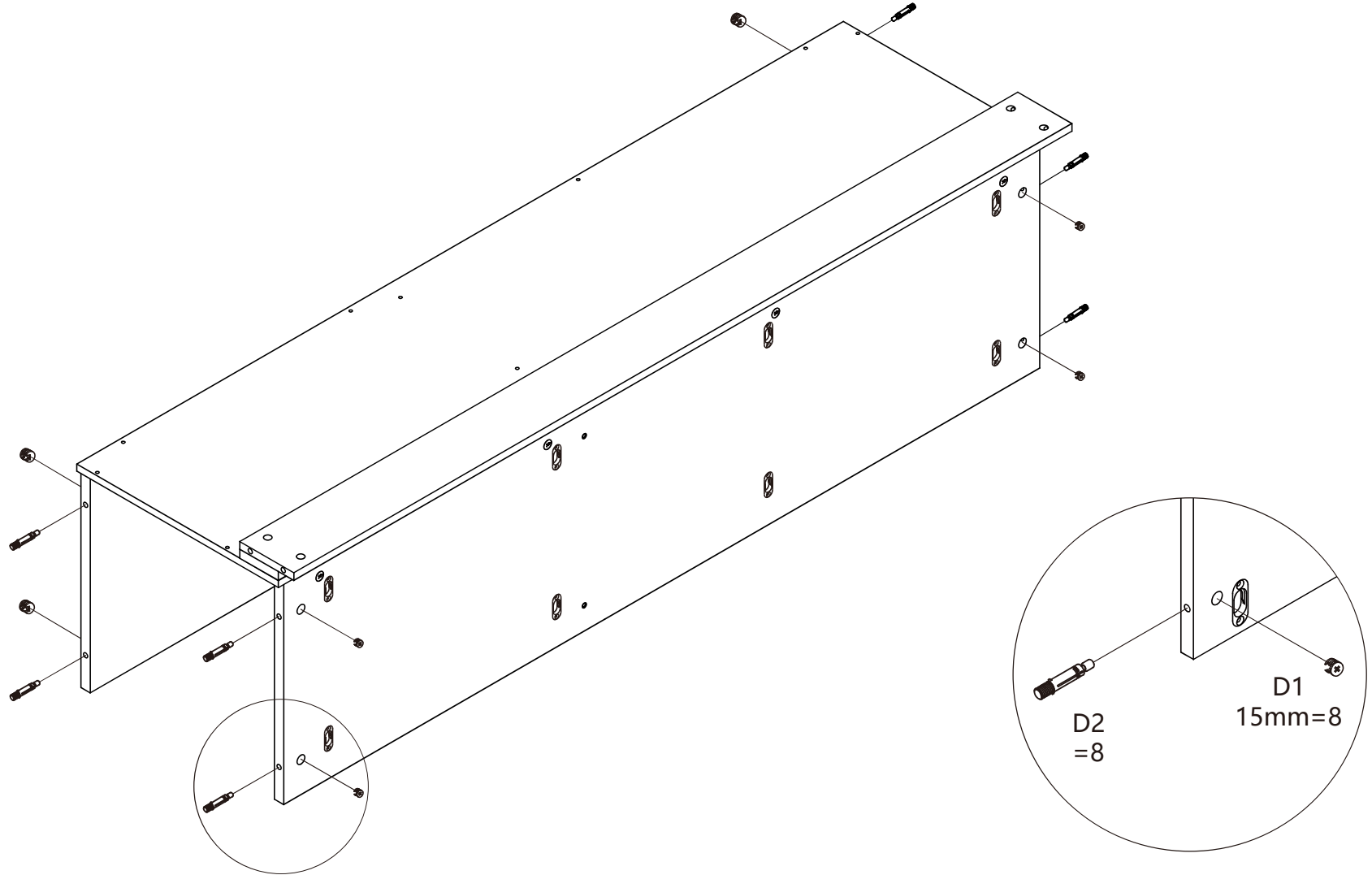

D1  
15mm=8



D2=8



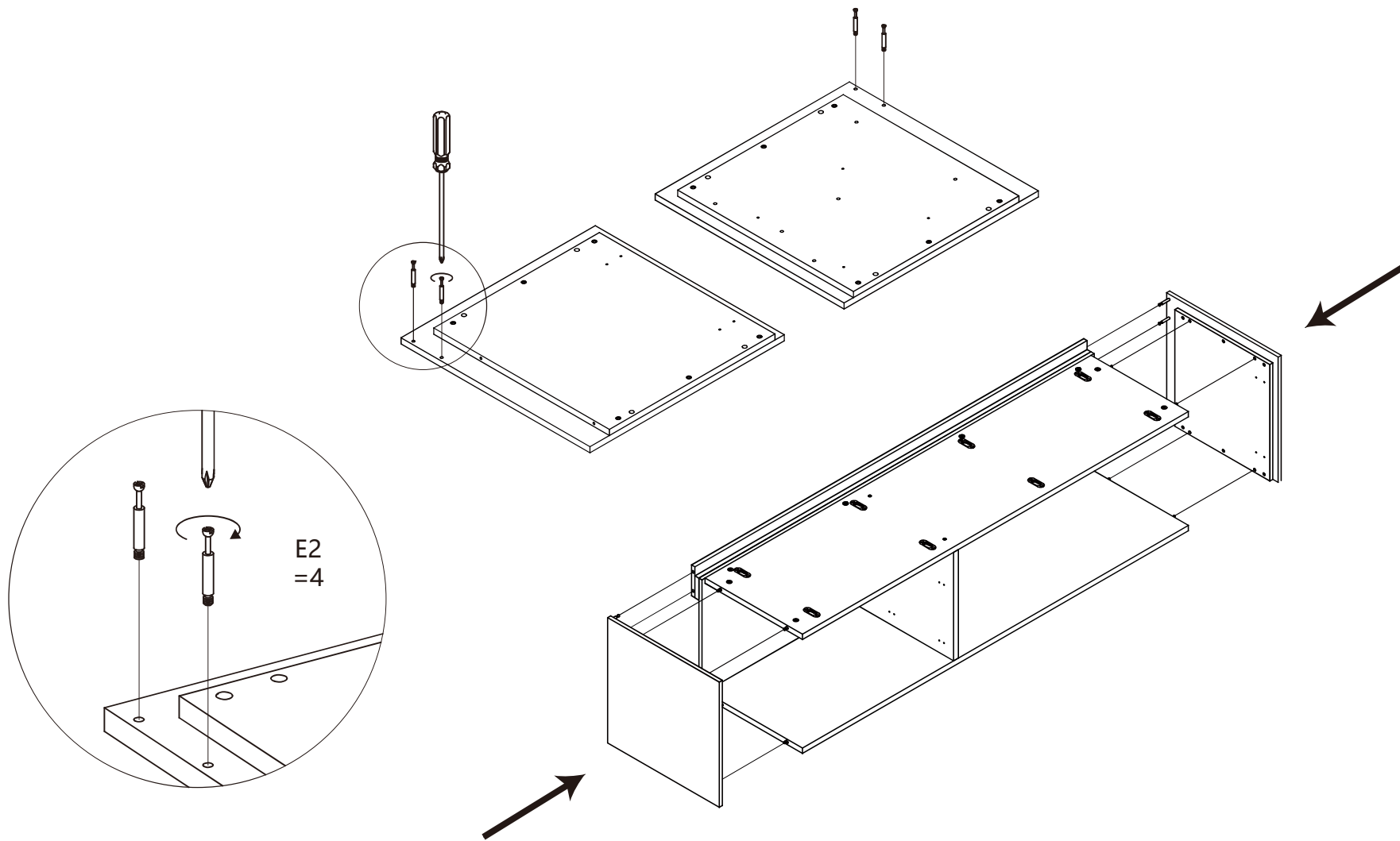

E2  
=4

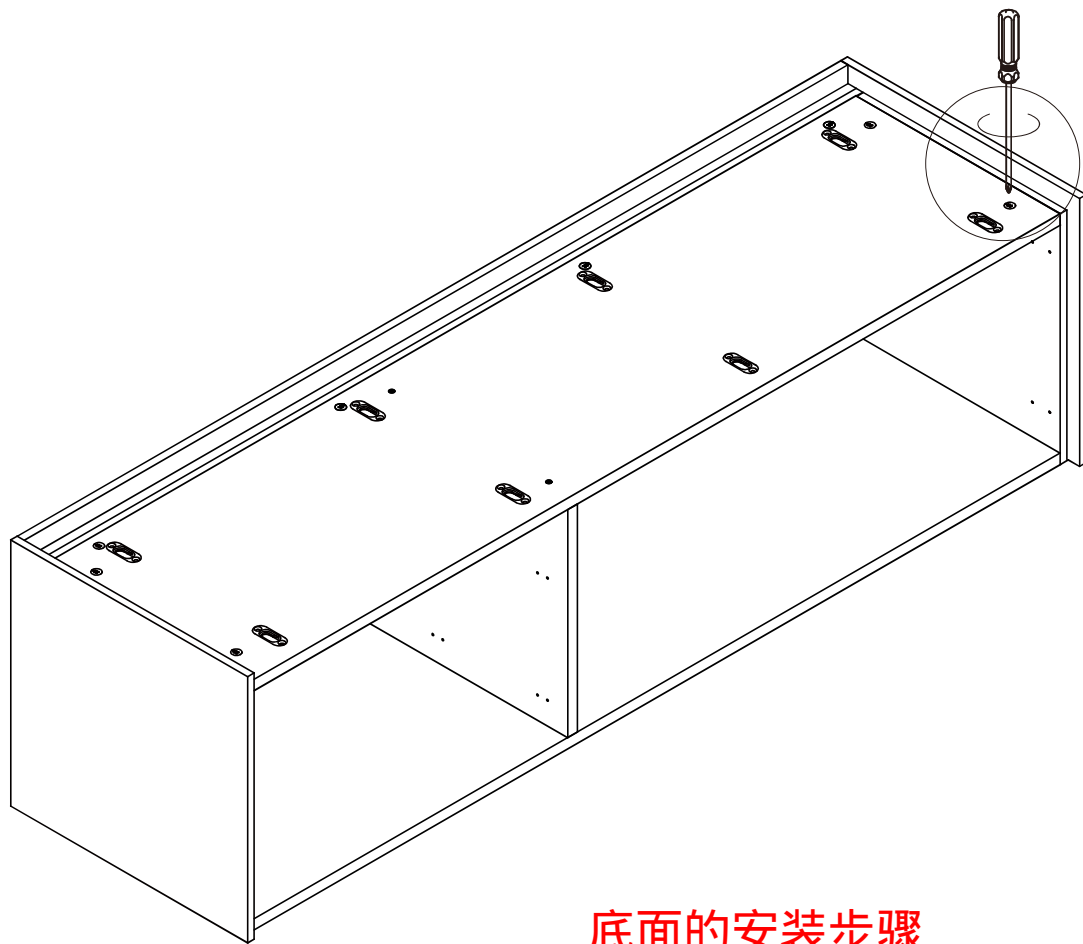

底面的安装步骤

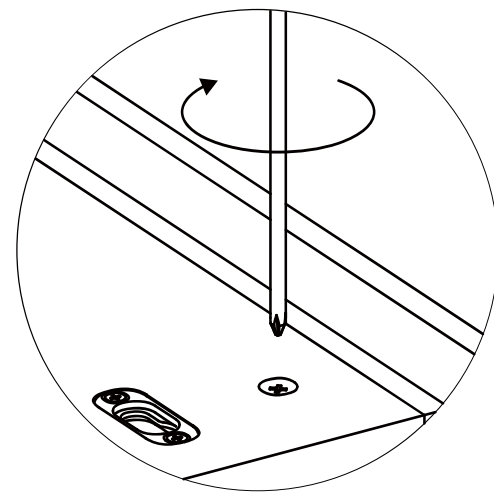

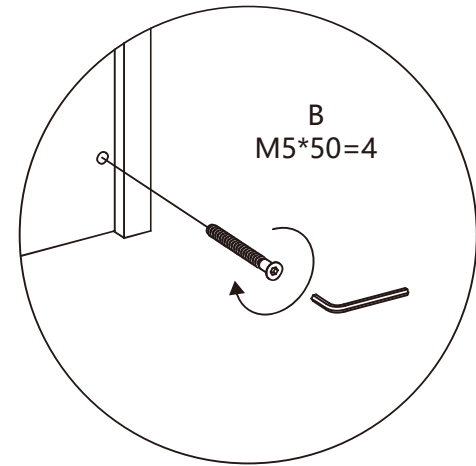
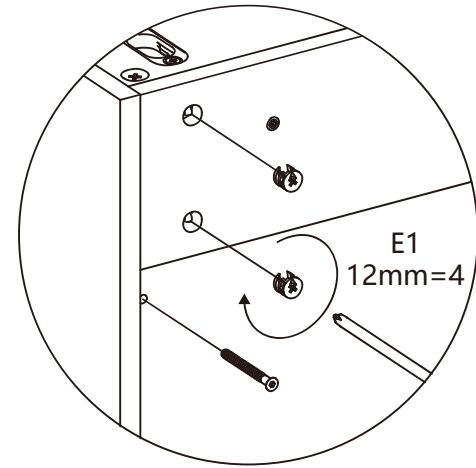
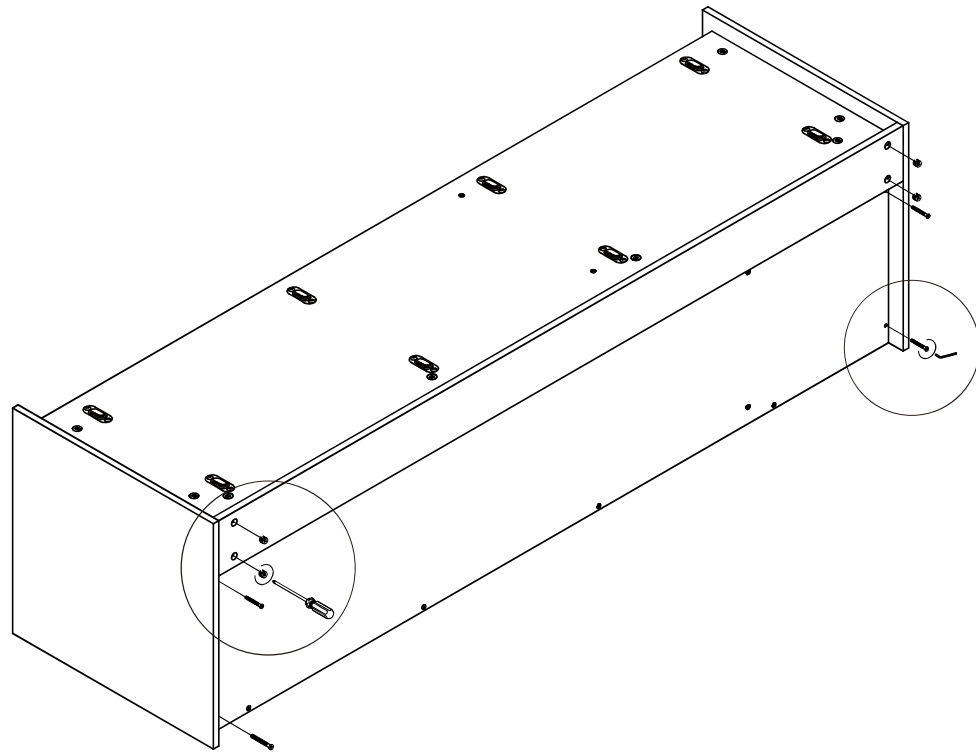

B  
M5\*50=4



E1  
12mm=4

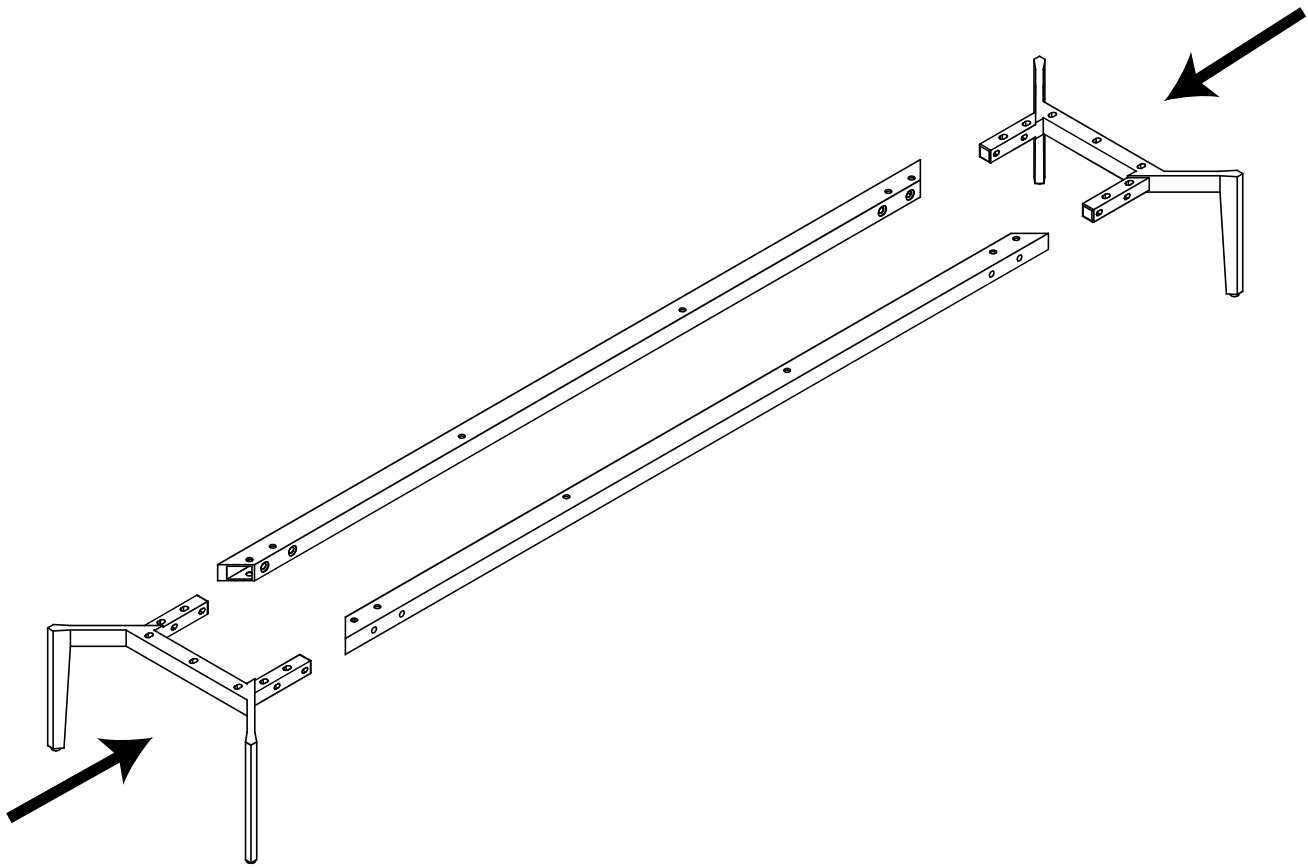

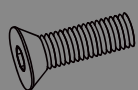
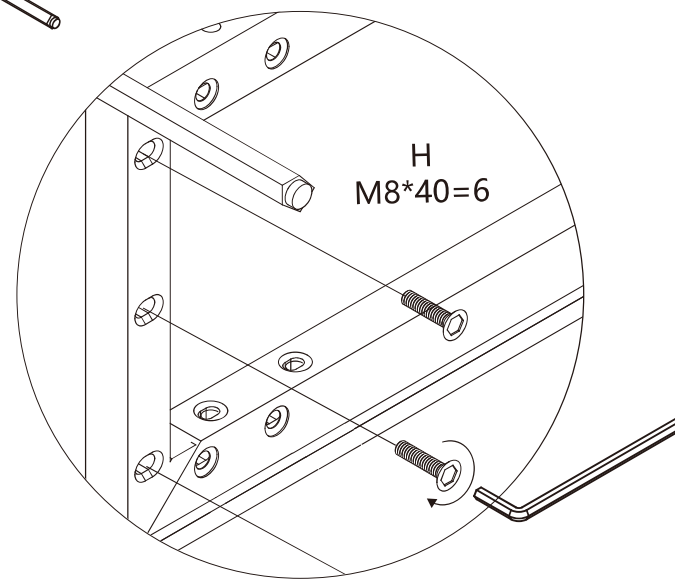
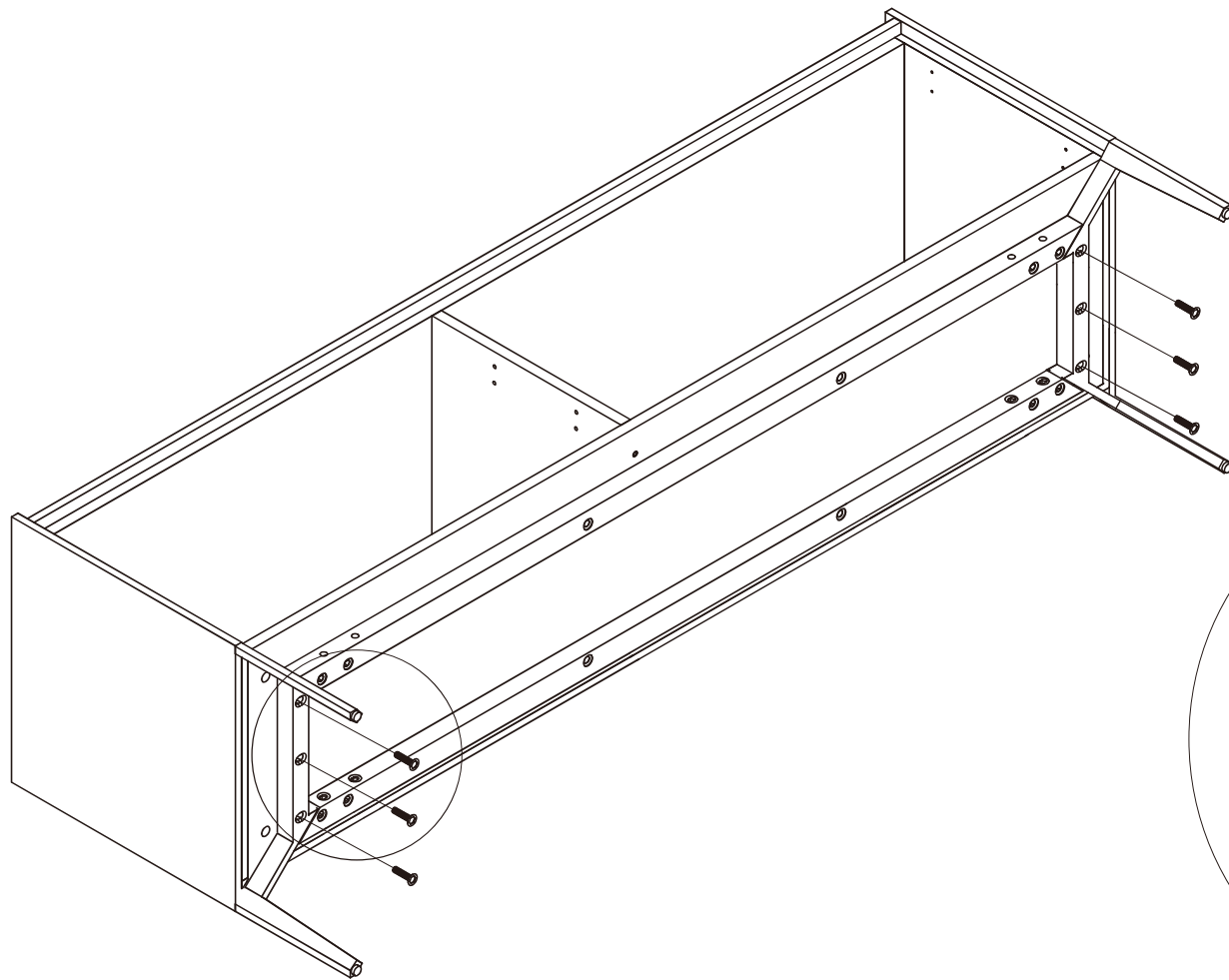

H  
M8\*40=6



G  
5mm=1

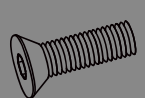
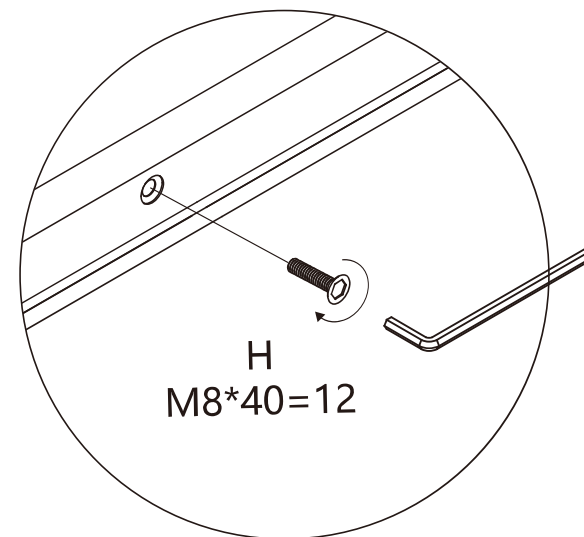
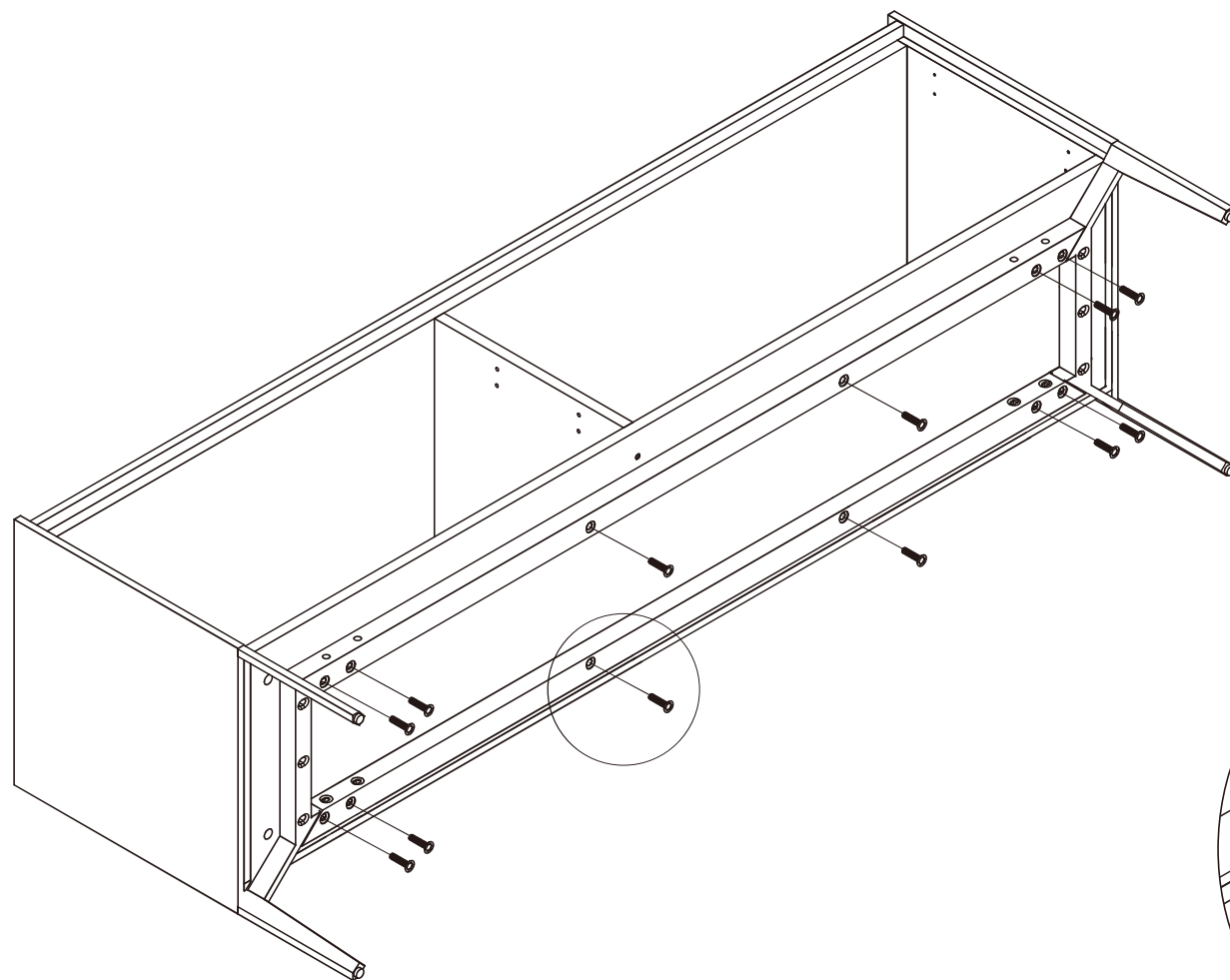

H  
M8\*40=12

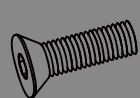
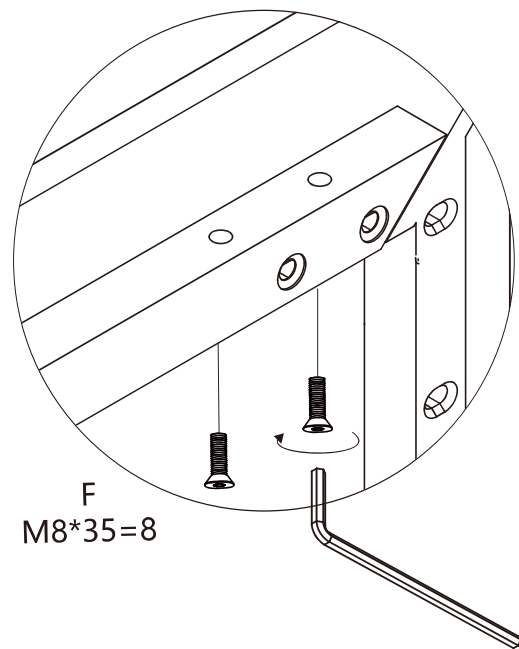
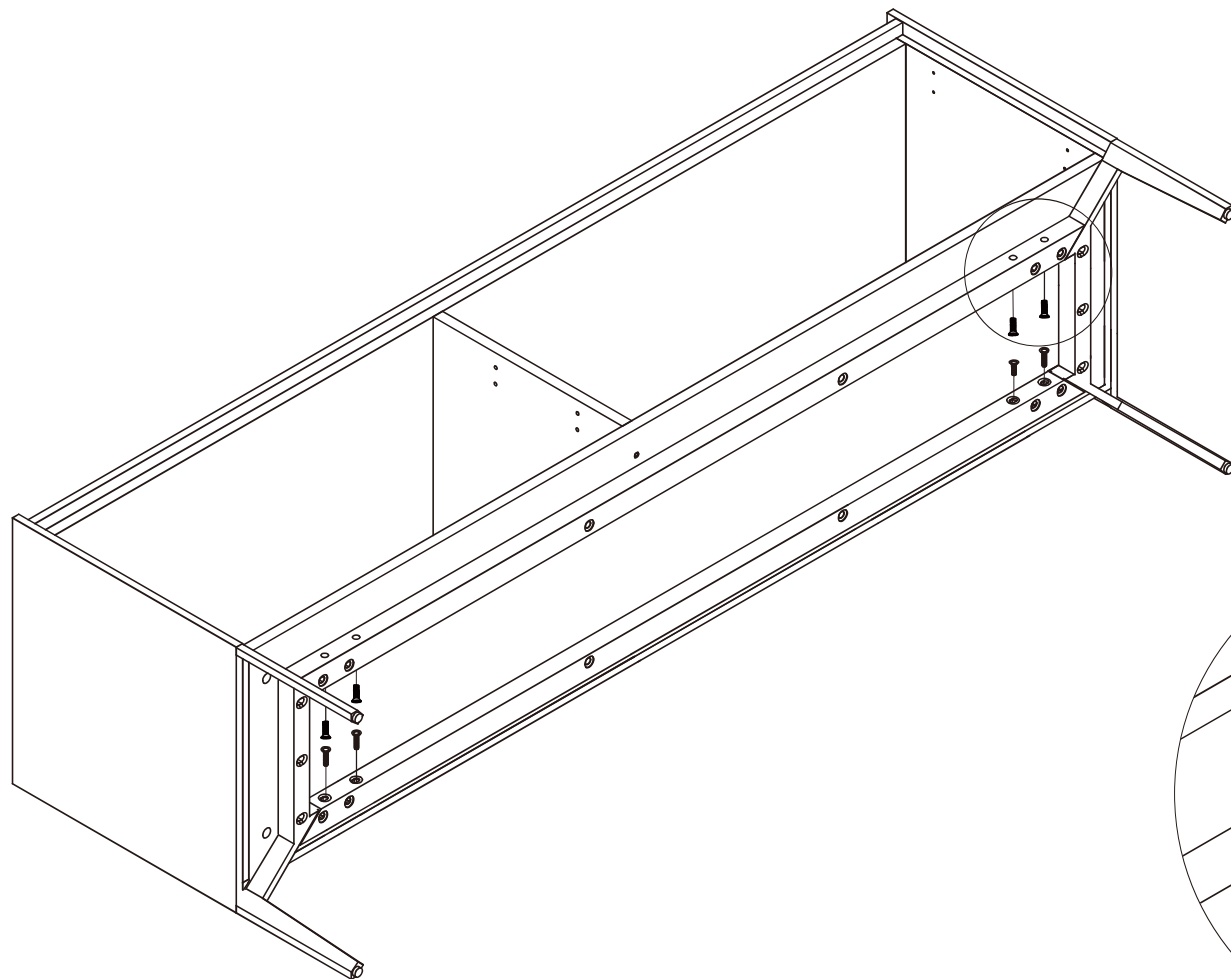

F  
M8\*35=8

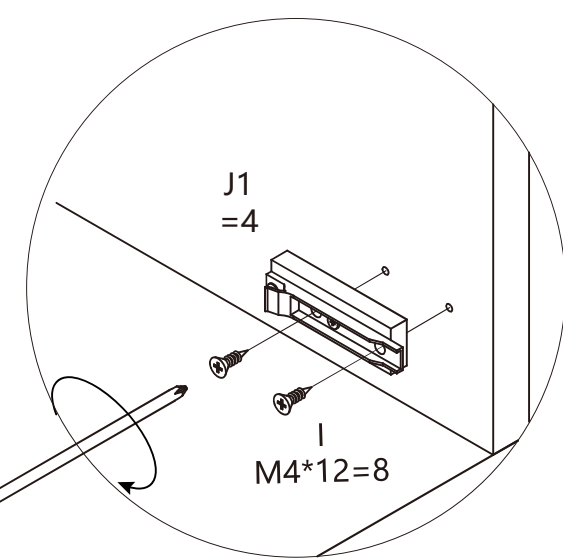
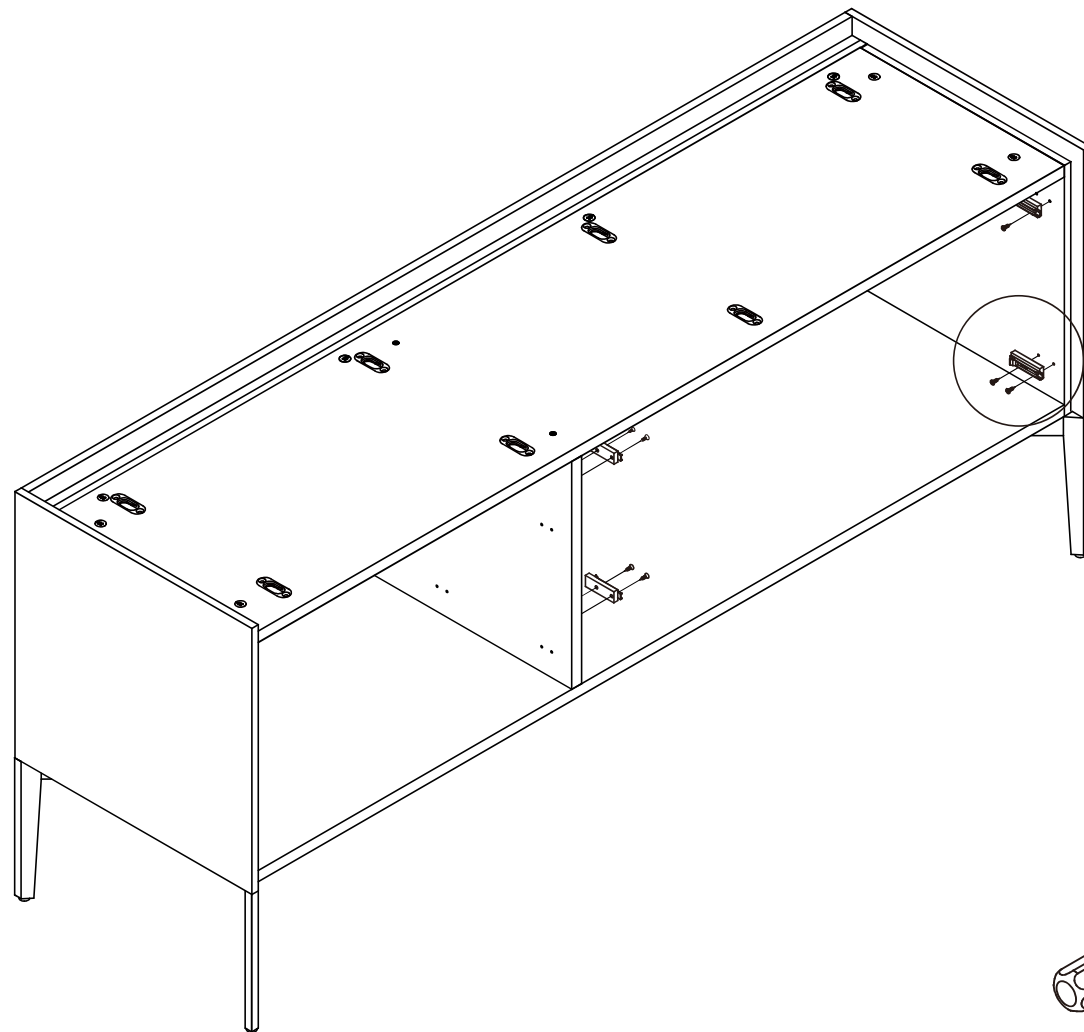

 |  
M4\*12=8

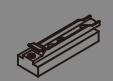

J1  
=4



调节完再装

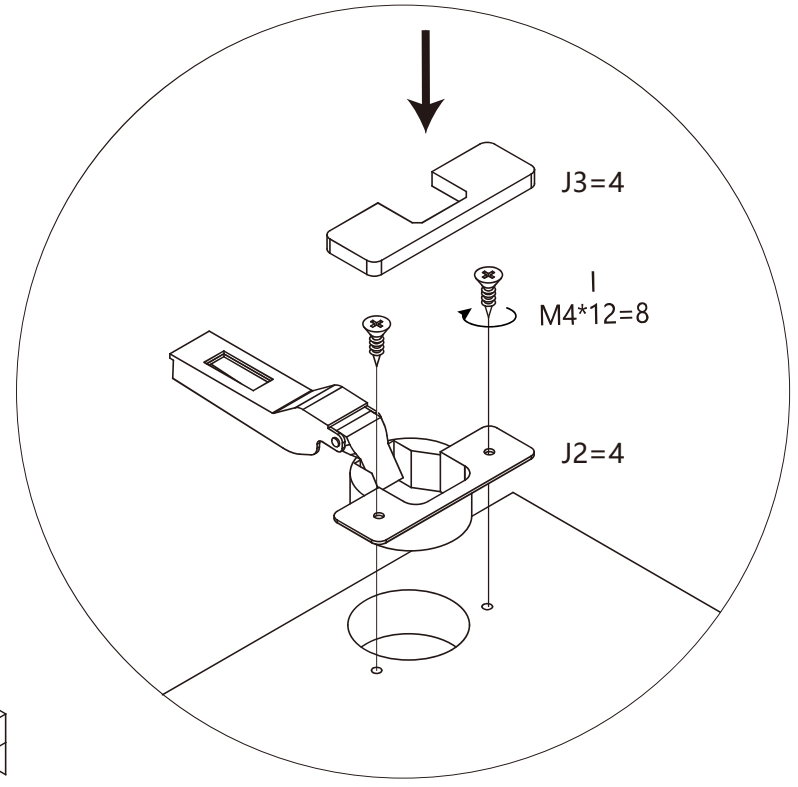
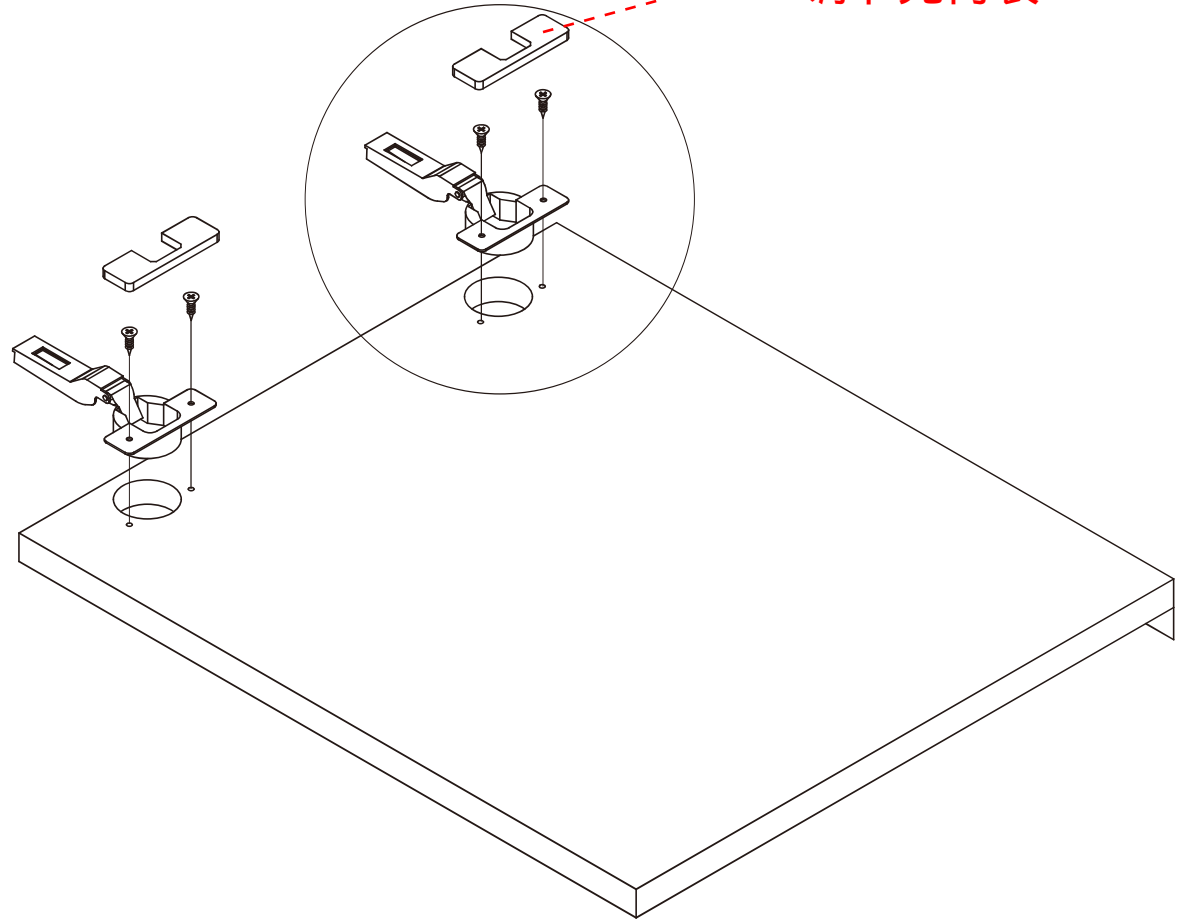

1  
M4\*12=8

J2  
=4

~~J3  
=4~~

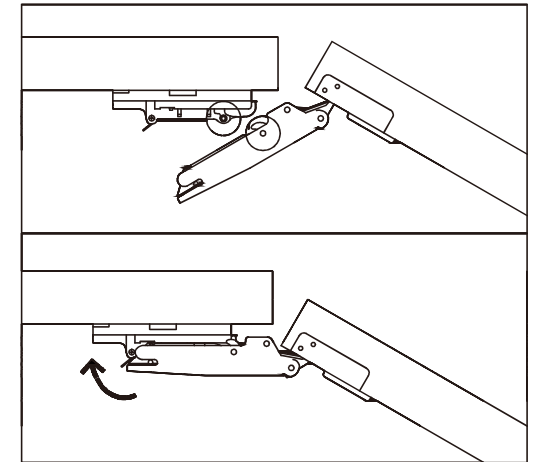
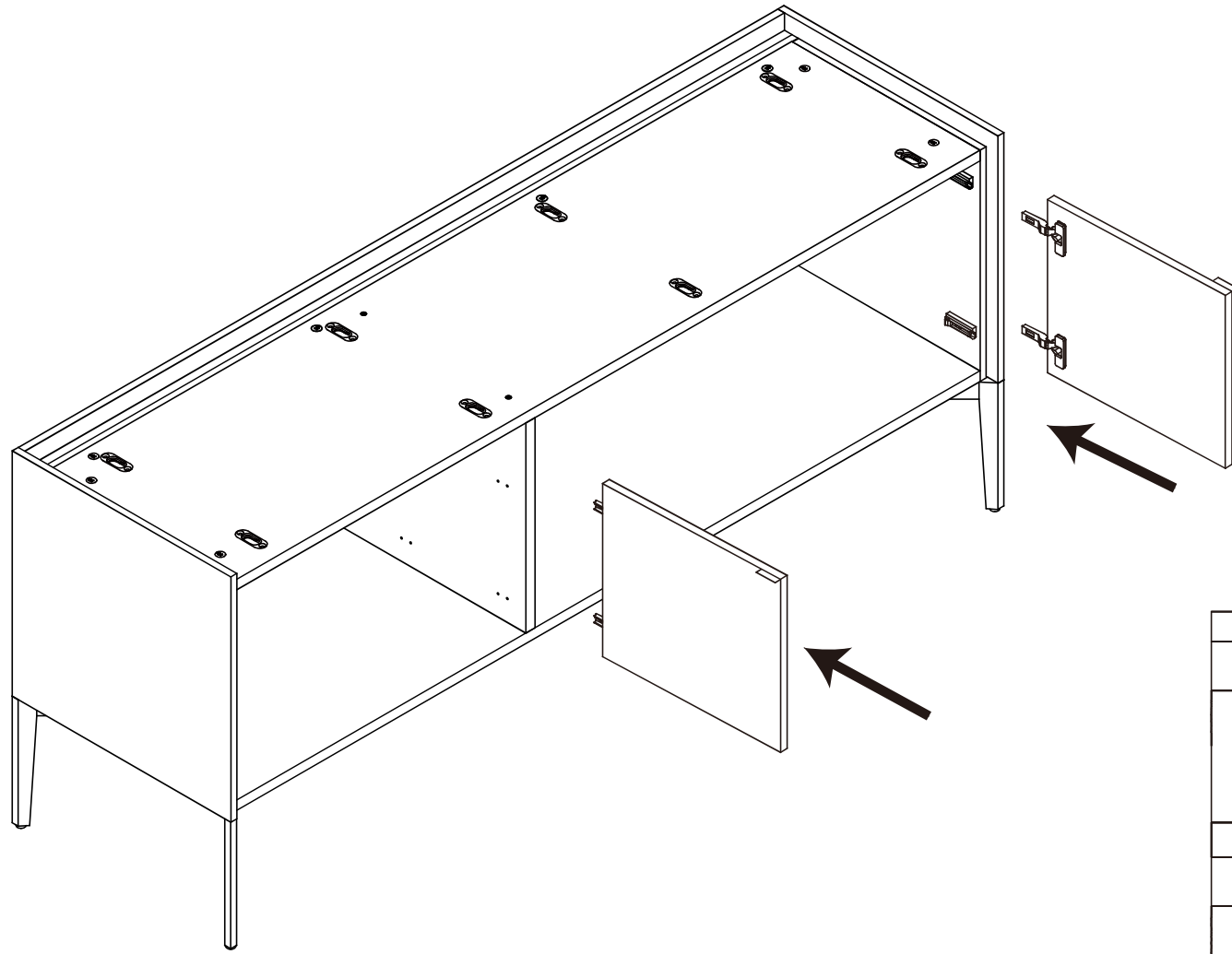

都装完再调节

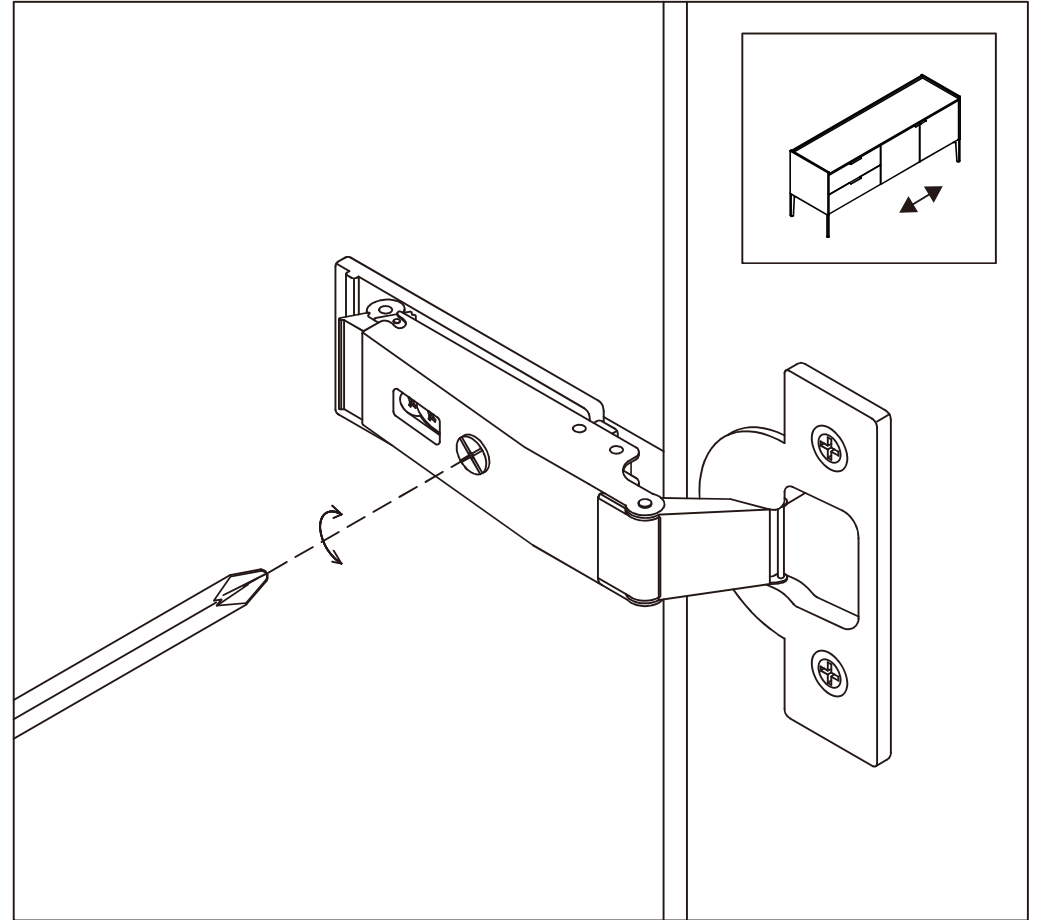
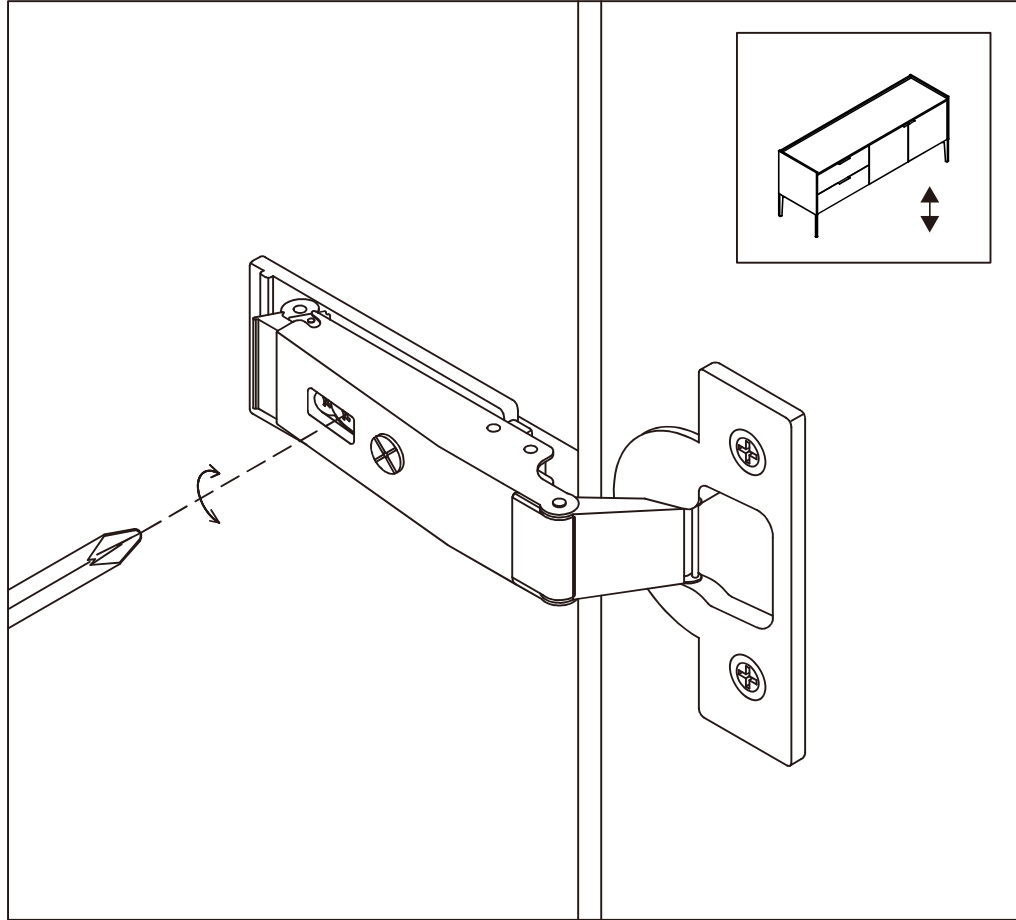

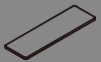
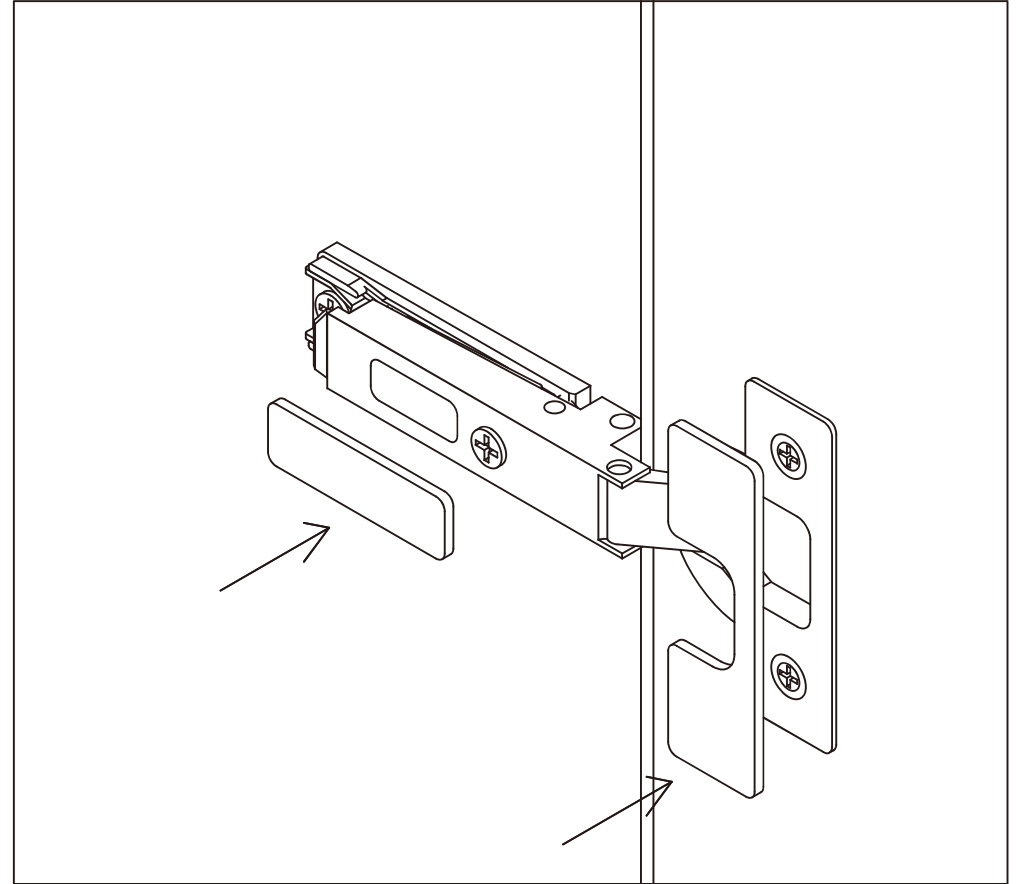
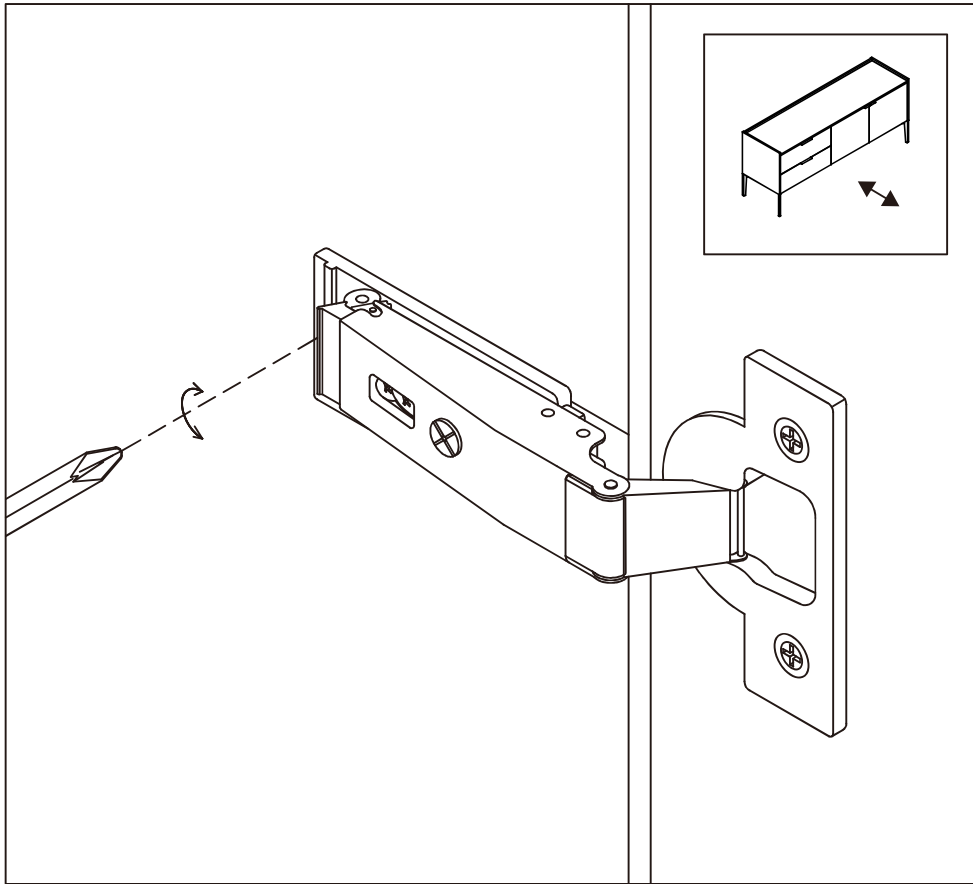

K4  
=4

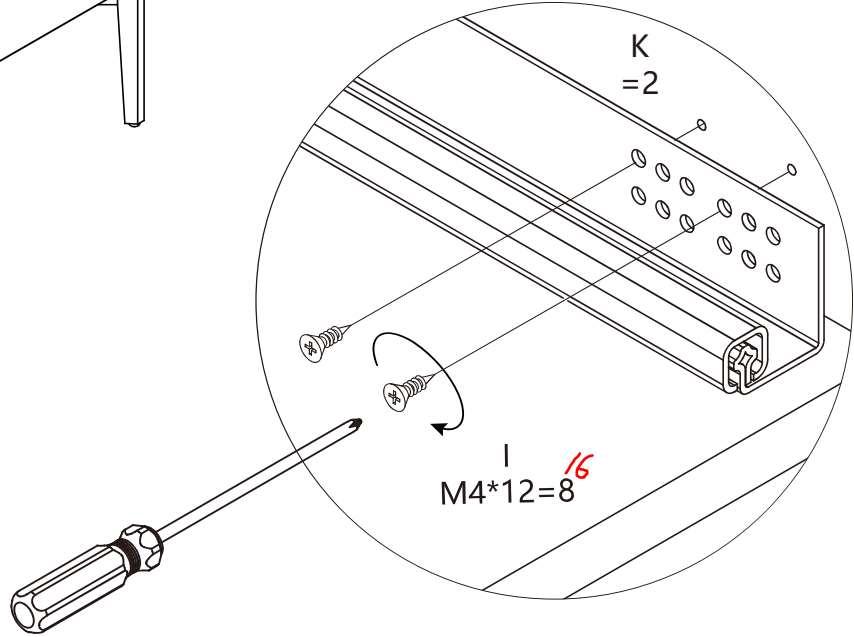
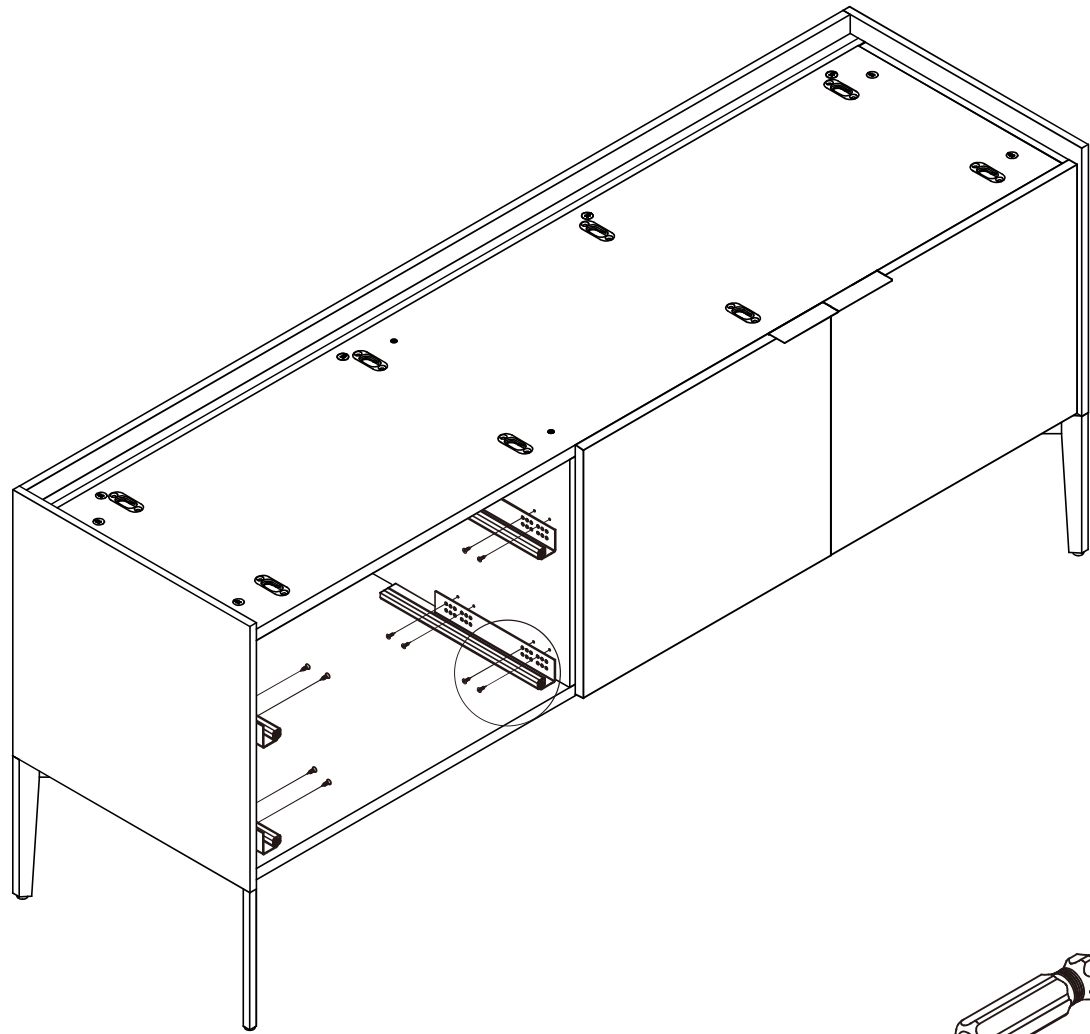

 I  
M4\*12=16

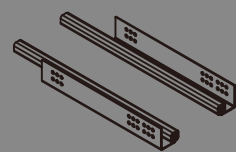
 K  
=2

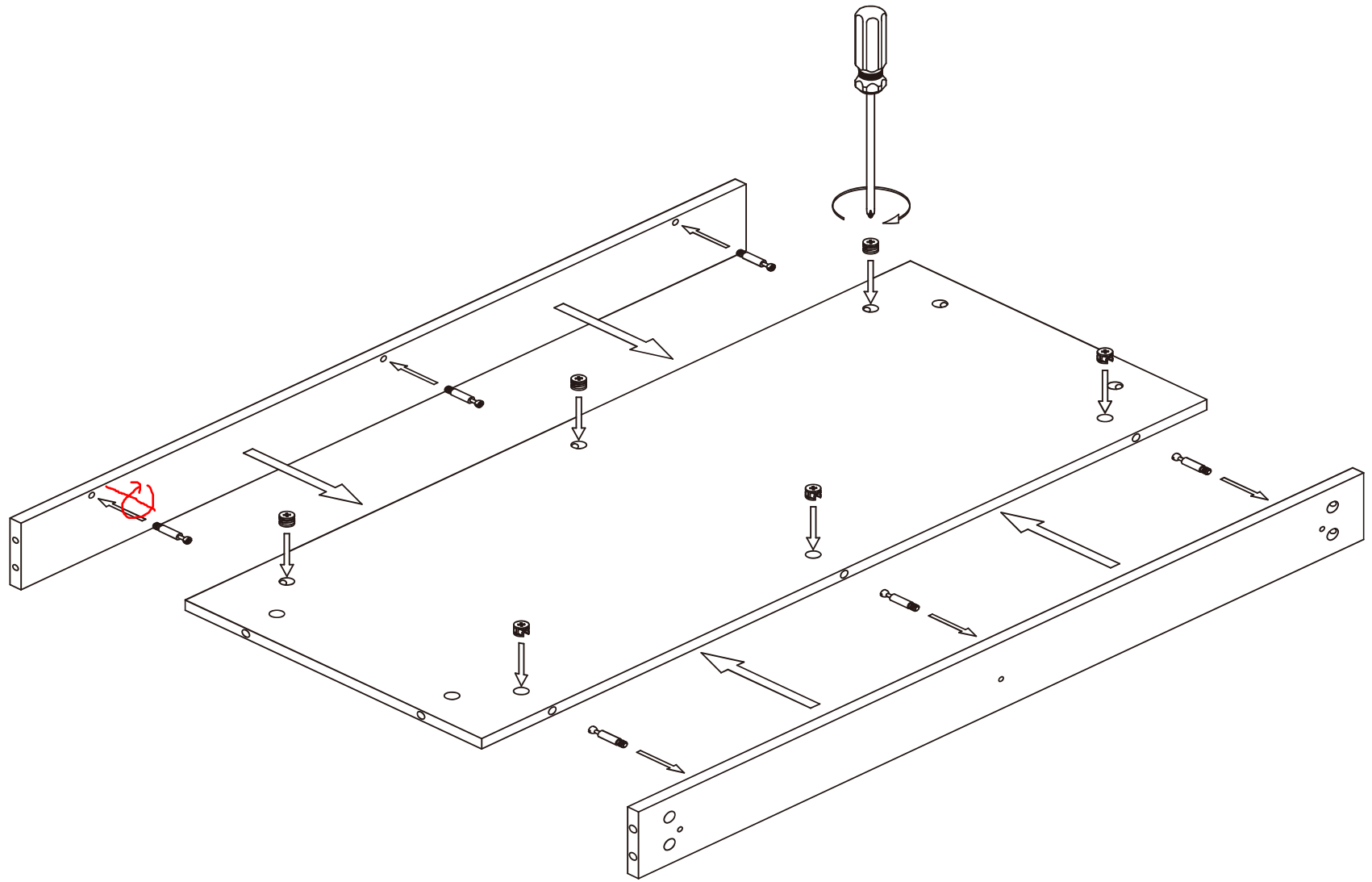

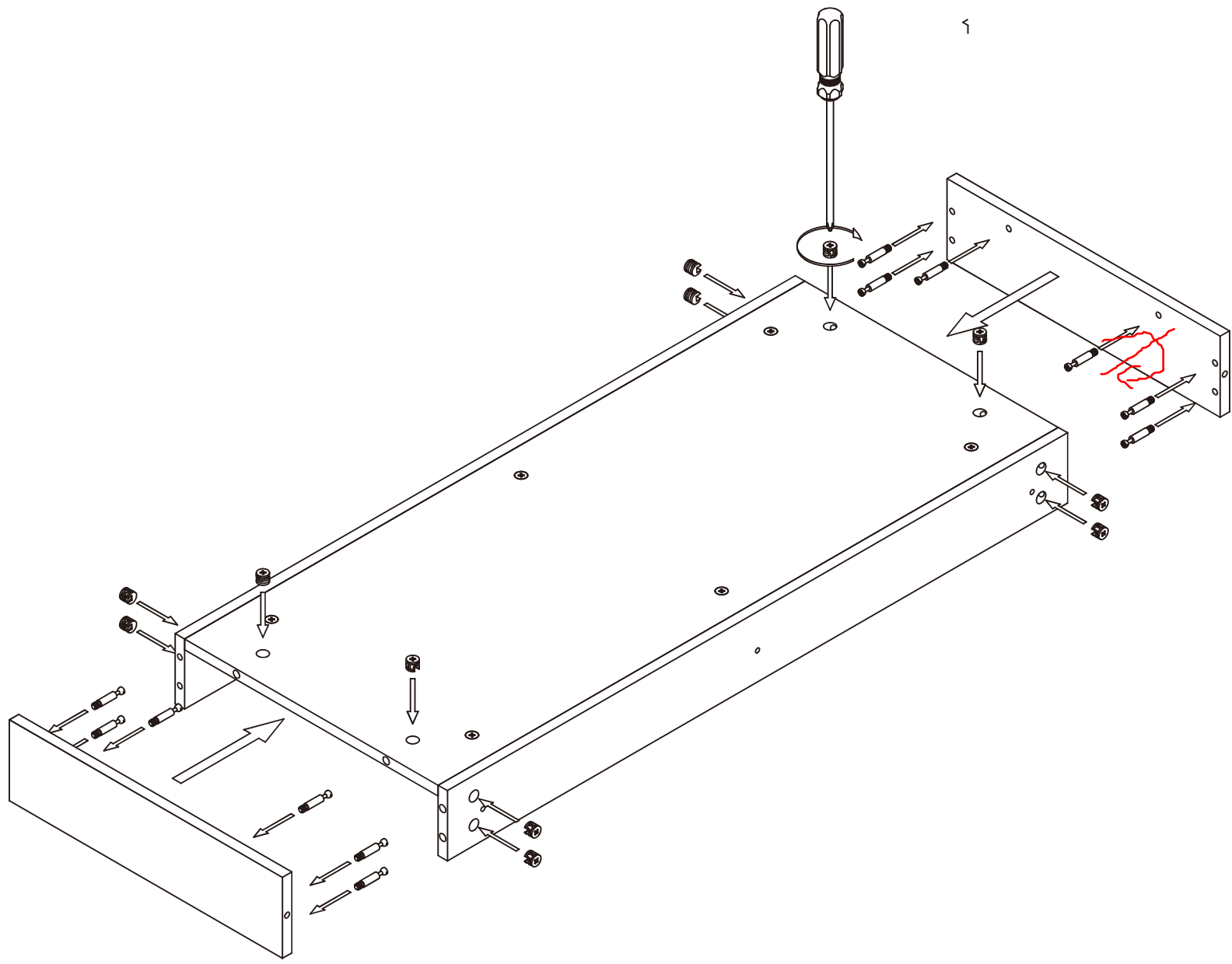

E1  
12mm=6  
E2  
=6



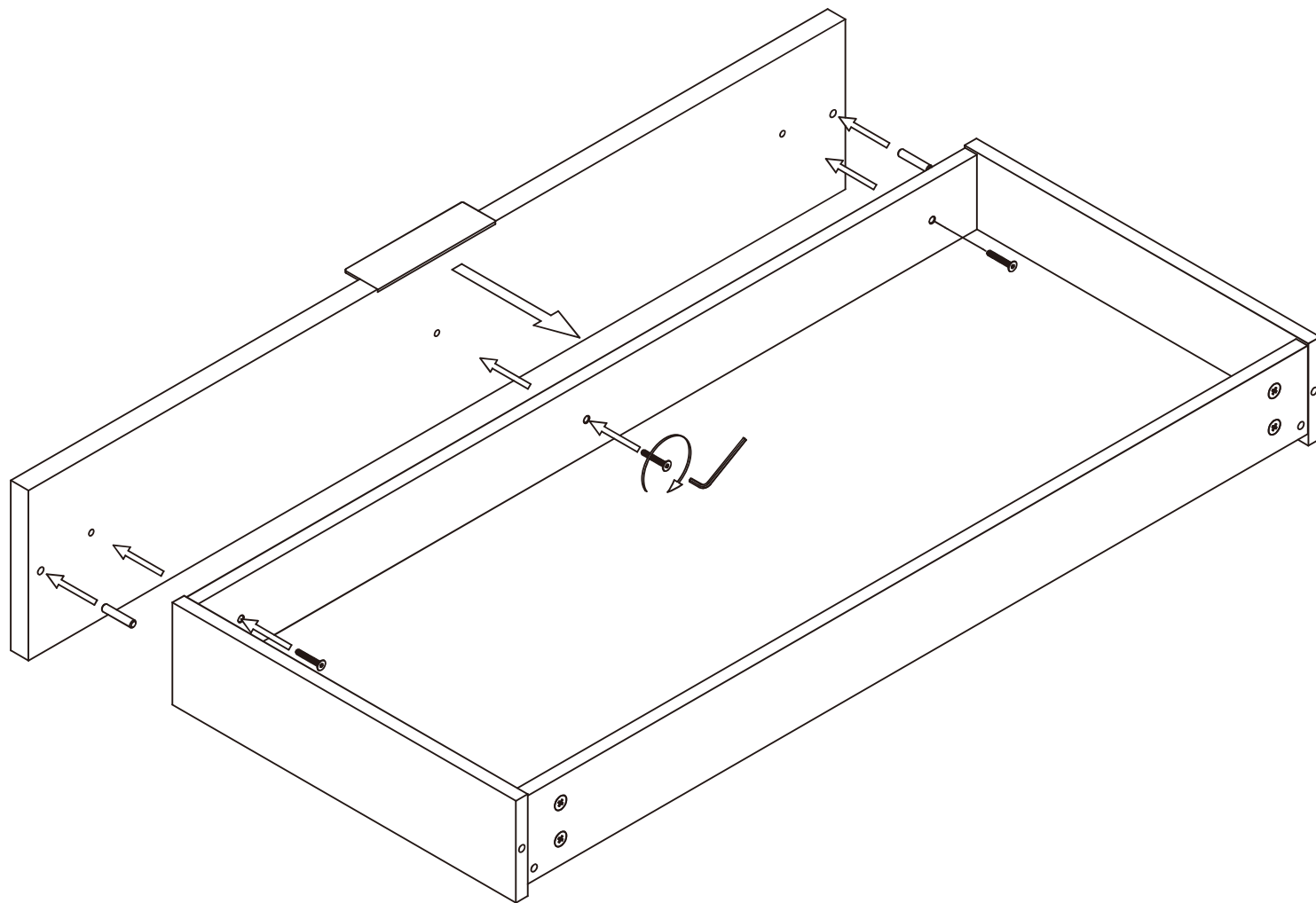

E1  
12mm=12

E2  
=12



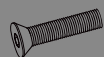

 L  
Φ6\*30=2

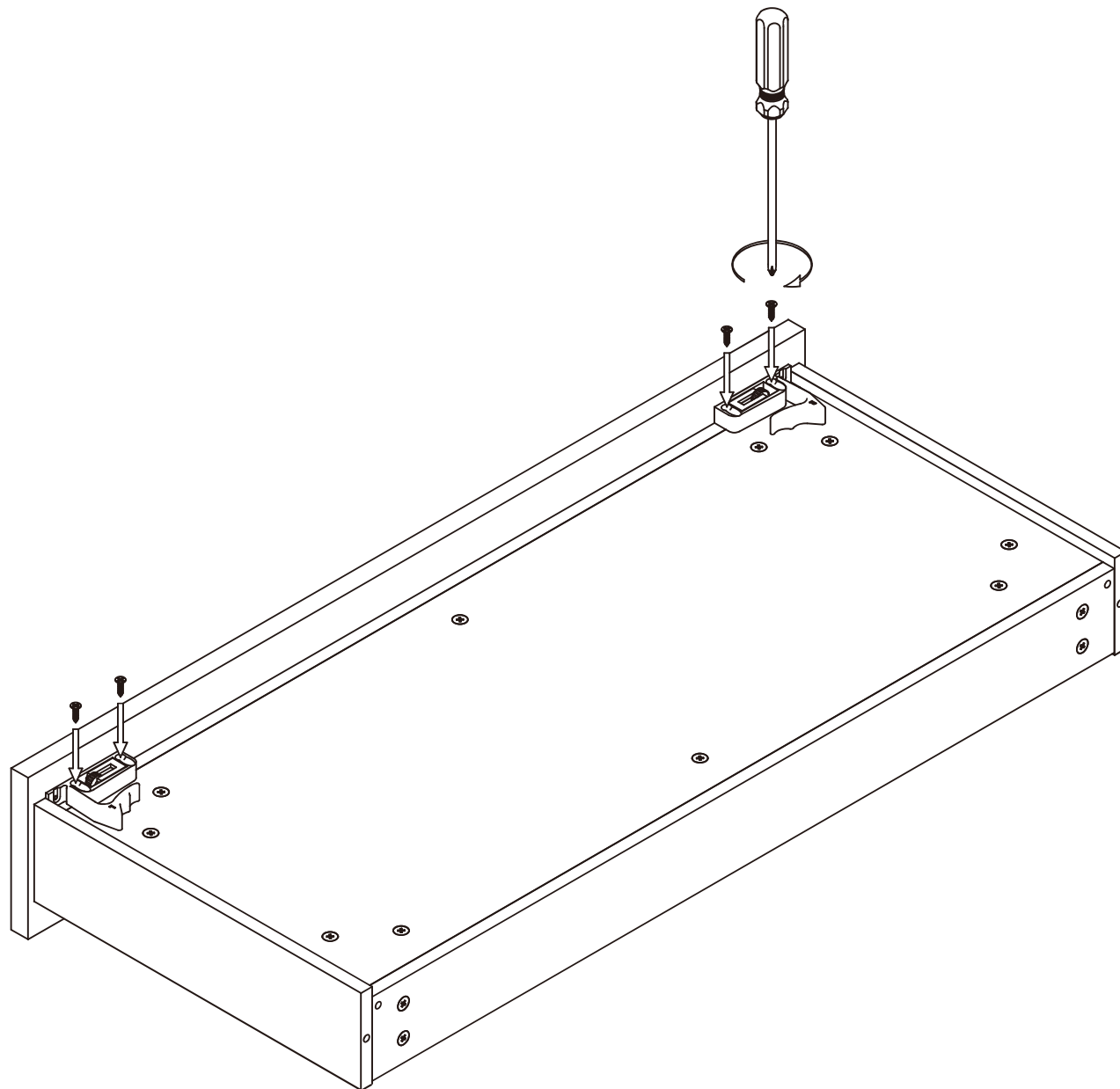

 M  
M4\*25=3

 N  
2.5mm=1





 Q  
M4\*16=4

  O  
=1

